

DEPARTMENT OF GENERAL SERVICES  
BUREAU OF BUILDING CONSTRUCTION

## Kringold Park

### Project Summary

The Department of Recreation and Parks plans to create a new active regional park on 100 plus acres in the South Carroll area. The park will include ball fields, multi-purpose fields, pavilions, a playground, and a parking area with 200 spaces. The park will also offer opportunities for fishing, hiking, and walking activities. The Kringold property, near Maryland Route 26 and Woodbine Road, will be the site for this new regional park. It is estimated by the Department of Recreation and Parks that annually there will be 30,000 individuals that will use the park.

### Parcel Information

- ✚ Street Address: 5355 Woodbine Road, Sykesville, Maryland
- ✚ Acreage: ~ 139.56 acres
- ✚ Tax Map 67, Grid 14, Parcel 30
- ✚ Election District: 14
- ✚ Zoning: Conservation

### Project Architect

- ✚ Whitney, Bailey, Cox & Manani
- ✚ Design started December 1, 2005

### Contractor

- ✚ Project has not been bid for construction

### Project Timeline

- ✚ Bid February 2009

### Budget

- ✚ Program Open Space funding, through the MD Dept. of Natural Resources, will fund a significant portion of the development

### Contact Information

- ✚ Dean Leister, Project Manager, Carroll County Bureau



Future Location of Kringold Park,  
Map 67, Grid 14, Parcel 30

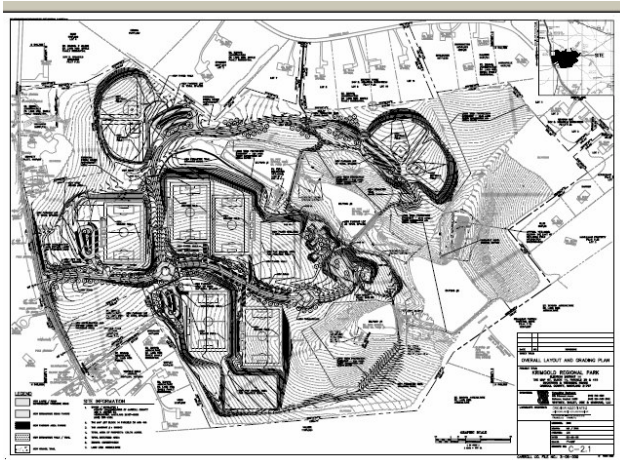

of Building Construction;  
Telephone No. 410-386-2218

**For more Information** - To sign-up for updates to this project or other Community Improvement projects by e-mail, go to the County's Subscribe link or click on the link below.

[http://service.govdelivery.com/service/multi\\_subscribe.html?code=MDCARROLL&origin=http://ccgovernment.carr.org/ccg/default.asp](http://service.govdelivery.com/service/multi_subscribe.html?code=MDCARROLL&origin=http://ccgovernment.carr.org/ccg/default.asp)

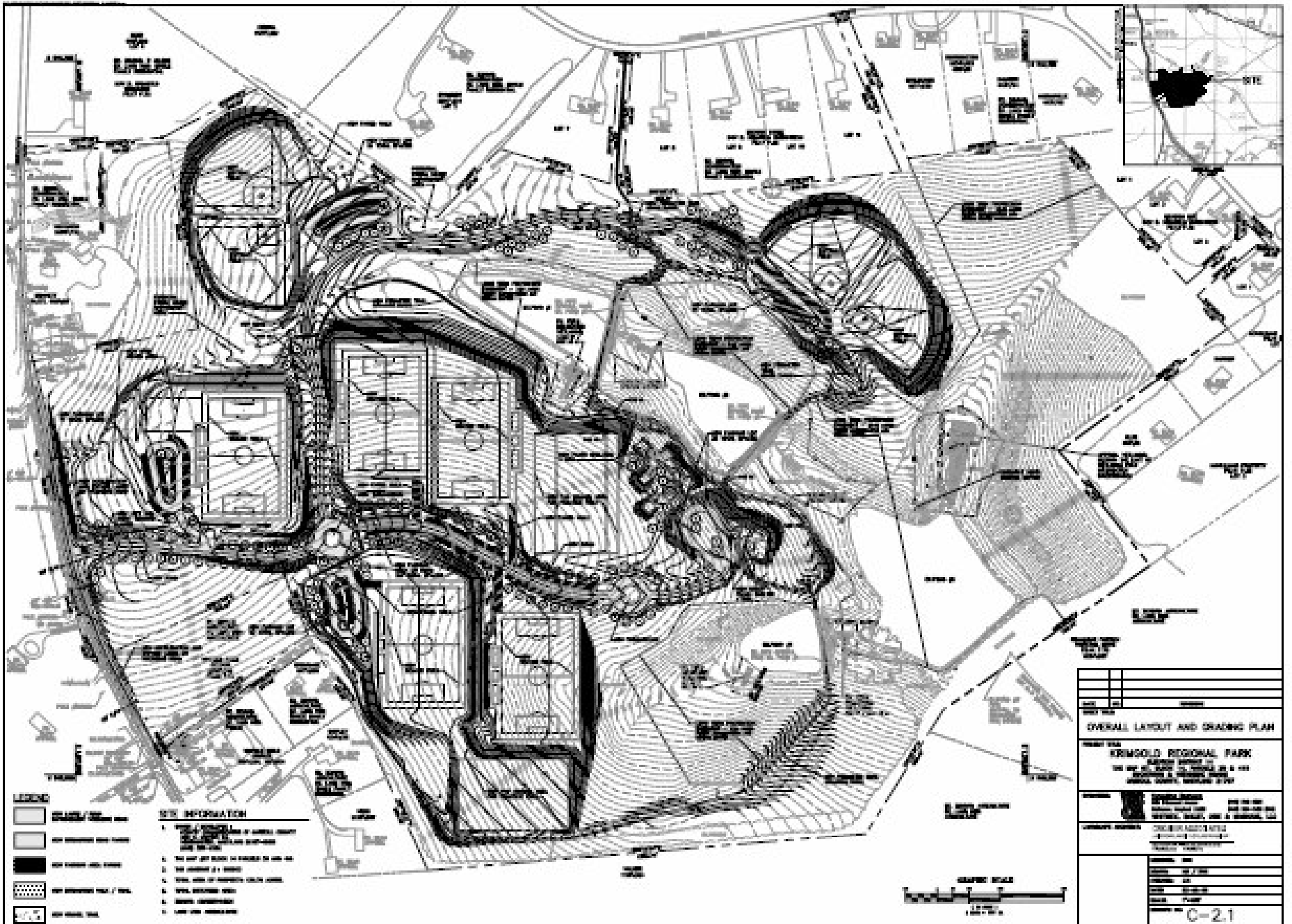

**LEGEND**

- EXISTING STRUCTURE
- PROPOSED STRUCTURE
- EXISTING DRIVEWAY
- PROPOSED DRIVEWAY
- EXISTING SIDEWALK
- PROPOSED SIDEWALK
- EXISTING UTILITY
- PROPOSED UTILITY

**SITE INFORMATION**

1. THE SITE IS LOCATED IN THE CITY OF KENT, WASHINGTON.
2. THE SITE IS ZONED R-1 (RESIDENTIAL SINGLE-FAMILY).
3. THE SITE IS LOCATED ON THE EAST SIDE OF 10000 S. 100TH ST., BETWEEN S. 101ST ST. AND S. 99TH ST.
4. THE SITE IS ADJACENT TO THE KENT AIRPORT.
5. THE SITE IS ADJACENT TO THE KENT RAILROAD.
6. THE SITE IS ADJACENT TO THE KENT WATER TREATMENT PLANT.
7. THE SITE IS ADJACENT TO THE KENT WASTE WATER TREATMENT PLANT.

|   |             |             |      |          |      |            |      |       |      |             |      |
|---|-------------|-------------|------|----------|------|------------|------|-------|------|-------------|------|
| DATE  | DESCRIPTION |             |      |          |      |            |      |       |      |             |      |
|   |             |             |      |          |      |            |      |       |      |             |      |
|   |             |             |      |          |      |            |      |       |      |             |      |
|   |             |             |      |          |      |            |      |       |      |             |      |
| <b>OVERALL LAYOUT AND GRADING PLAN</b>  |             |             |      |          |      |            |      |       |      |             |      |
| <b>KRIMGOLD REGIONAL PARK</b>   |             |             |      |          |      |            |      |       |      |             |      |
| 10000 S. 100TH ST., KENT, WA 98032  |             |             |      |          |      |            |      |       |      |             |      |
| ADJACENT TO KENT AIRPORT  |             |             |      |          |      |            |      |       |      |             |      |
| ADJACENT TO KENT RAILROAD   |             |             |      |          |      |            |      |       |      |             |      |
| ADJACENT TO KENT WATER TREATMENT PLANT  |             |             |      |          |      |            |      |       |      |             |      |
| ADJACENT TO KENT WASTE WATER TREATMENT PLANT  |             |             |      |          |      |            |      |       |      |             |      |
| <table border="1"> <tr> <td>DESIGNED BY</td> <td>DATE</td> </tr> <tr> <td>DRAWN BY</td> <td>DATE</td> </tr> <tr> <td>CHECKED BY</td> <td>DATE</td> </tr> <tr> <td>SCALE</td> <td>DATE</td> </tr> <tr> <td>PROJECT NO.</td> <td>DATE</td> </tr> </table> |             | DESIGNED BY | DATE | DRAWN BY | DATE | CHECKED BY | DATE | SCALE | DATE | PROJECT NO. | DATE |
| DESIGNED BY   | DATE        |             |      |          |      |            |      |       |      |             |      |
| DRAWN BY  | DATE        |             |      |          |      |            |      |       |      |             |      |
| CHECKED BY  | DATE        |             |      |          |      |            |      |       |      |             |      |
| SCALE   | DATE        |             |      |          |      |            |      |       |      |             |      |
| PROJECT NO.   | DATE        |             |      |          |      |            |      |       |      |             |      |
| <b>C-2.1</b>  |             |             |      |          |      |            |      |       |      |             |      |

